

Maramatanga Park Concept Plan

Decision Story

Thank you for taking part in the Concept Planning for Maramatanga Park. We have completed the Plan and this document contains information on some of the key issues, themes of community feedback and the decisions.

What's the story?

Council looks after more than 200 reserves in the Western Bay. Our Reserve Management Plans set the rules for each reserve and provide a vision for how we use and develop the public spaces for, and with, our communities. The Kaimai Ward Reserve Management Plan was prepared in October 2003, reviewed in October 2008, and again in August 2016. During the latest review it was agreed that the existing concept plans for Maramatanga Park would be reviewed.

Creating a draft plan

The draft concept plan was prepared from community feedback during the Kaimai Ward Reserve Management Plan review, information held on Council files and from the collective knowledge held by Council staff. Opportunities to provide feedback to the concept plan was available during the Long Term Plan Community Conversations held at Omokoroa on 6 May and 6 June 2017 and at Te Puna on 27 May 2017.

Engaging with the community

Community engagement for the draft plan started mid August 2017 with advertisements in local newspapers, written invitations to hapū, marae and stakeholders and a notice on Council's web page. Consultation ended on 15 September 2017. People were able to give feedback through our website, or by filling out submission forms at our libraries and offices.

A drop-in day to allow elected members and staff to provide information about the draft plan was held at Maramatanga Park on Saturday, 2 September 2017.

Those who wished to discuss their feedback on the draft concept plan with elected members attended a meeting held in Council Chambers on 5 December 2018.

Our response to your feedback

We received 21 submissions including positive feedback about the key features of the draft plan. A copy of the approved plan is provided in this decision story and if you are interested, all the approved concept plans will be posted on our webpage for the next two months.

What will Maramatanga Park be used for?

Maramatanga Park is one of the District's premier parks. The feedback provided about the sports fields was positive and gave us a good insight into what we need to discuss with users for the long-term and as issues arise. Through the Concept Plan process we try to anticipate what current and potential users would like developed – both for the present and the future.

We are heartened by the comments made about the connection the Park has to Pirirakau hapū.

Therefore it is appropriate for the Concept Plan to acknowledge that relationship by including the following:

- Opportunity to erect appropriate pou to signify and strengthen the relationship of Pirirakau to the park.

Considerable support was shown for new cycleway connection to the Park but there were concerns about the impact of the lack of car parks and the need for an additional toilet. We will be monitoring the impact of the cycleway including provision of car parks, toilet facilities, drinking water etc at Maramatanga Park. The proposed overflow locations shown in the Concept Plan can be amended as the impacts become clearer.

Members of the Tennis Club commented about the need to expand, but another submitter suggested extra courts were not needed. We continue to have a good working relationship with the Club and managing court space at Maramatanga Park has always been a priority for Council.

Feedback on the Te Puna Community Centre highlighted the need for an upgrade. The building is owned by the local Community Trust who is responsible for planning ongoing maintenance and capital development of the building including renovations and upgrades. Rates are collected from a Te Puna area of benefit, which Council administers on behalf of ratepayers. This funds maintenance and capital development of the Community Centre and the Te Puna War Memorial Hall. The respective committees continue to work with Council to plan how the funds are spent but our role is limited. The respective committees are encouraged to seek the involvement of other parties and agencies to assist with funding via grants etc. Council welcomes an invitation from the committees to discuss options.

The nine fitness stations spread around the park were installed in 2008.

We will be initiating a review of Dog Exercise Areas in the District in 2018/19, as signalled through our Dog Control Policy and Bylaw review in 2017.

What are we getting in the park?

We received many comments supporting the proposed skate park and playground. Over recent years there has been a lot of support for these play areas district-wide. Occasionally opposition arises due to concerns about the sites becoming magnets for anti-social behaviour. Council's experience with these types of facilities at Katikati, Omokoroa, Te Puke, Maketu and Waihi Beach is that they have proven very successful through their popularity and through support from committed committees.

Council's commitment to funding will come from a mix of sources including rates, financial contributions, but most importantly, from a cost-share arrangement with the community. If the Maramatanga Park skate park project is to proceed, a community group will need to be established to work with Council to assist with designing the facilities and coordinating fundraising for the community's contribution.

The concept plan identifies potential sites to enable further discussion to assist the design and funding stage which will also include assessments of access, location of services and the proposed new toilet.

Several people were concerned about the lack of public toilet options. Due to vandalism resulting from the toilet block being located at the rear of the Community Centre, we have kept it locked. We will continue to work with users to make sure the toilet key is available for organised events.

The plan identifies the location of a new toilet close to the proposed carpark, playground and skate park area to enable easy access. We anticipate the final location and timing of the toilet will coincide with completion of the design, assessments and funding stage of the proposed "play area" facilities.

Several Model Aircraft Club members supported the continued use of Maramatanga Park for flying. It is a permitted activity on reserves, which must meet the noise performance standards under the provisions of the District Plan. Council's Reserves and Facilities Bylaw also restricts how a person may operate power-driven model aircraft on a reserve. It is understood only electric model aircraft are used at the Park, which would need to meet the requirements above. Fuel or gas turbine powered planes are unlikely to be permitted because of the District Plan noise performance standards for the zone.

We have also given permission for all Remotely Piloted Aircraft Systems (drones) to use reserves, provided the bylaws and Civil Aviation Authority regulations are met.

Currently the Park is mown to the appropriate sports fields code standard, Type C – 20 to 40 mm grass height. Council would consider working with the Model Aircraft Club to arrange specific areas to be mown for the purposes of flying electric model aircraft. We would also use the opportunity to address any issues members may have regarding general use of the park and access to the toilet.

During community discussions, the idea of a future Community Centre for the wider Te Puna area was raised on the basis that it should be located on Council-owned land, i.e. Maramatanga Park. During this concept plan process, there was support for a future Community Centre at Maramatanga Park but rather than being site specific, the Plan would include a general statement: Potential future Community Centre building site to be determined later.

Several comments were made about the future use of the Park. The Concept Plan process endeavours to anticipate what current and potential users would like developed short and long term. Council takes on board the feedback received about the long term outlook.

Implementation of concept plans

Following adoption of the concept plans, implementation estimates will be prepared and referred to Council for consideration to allocate funds. This will also include the allocation of funds from cancelled projects or projects deferred indefinitely.



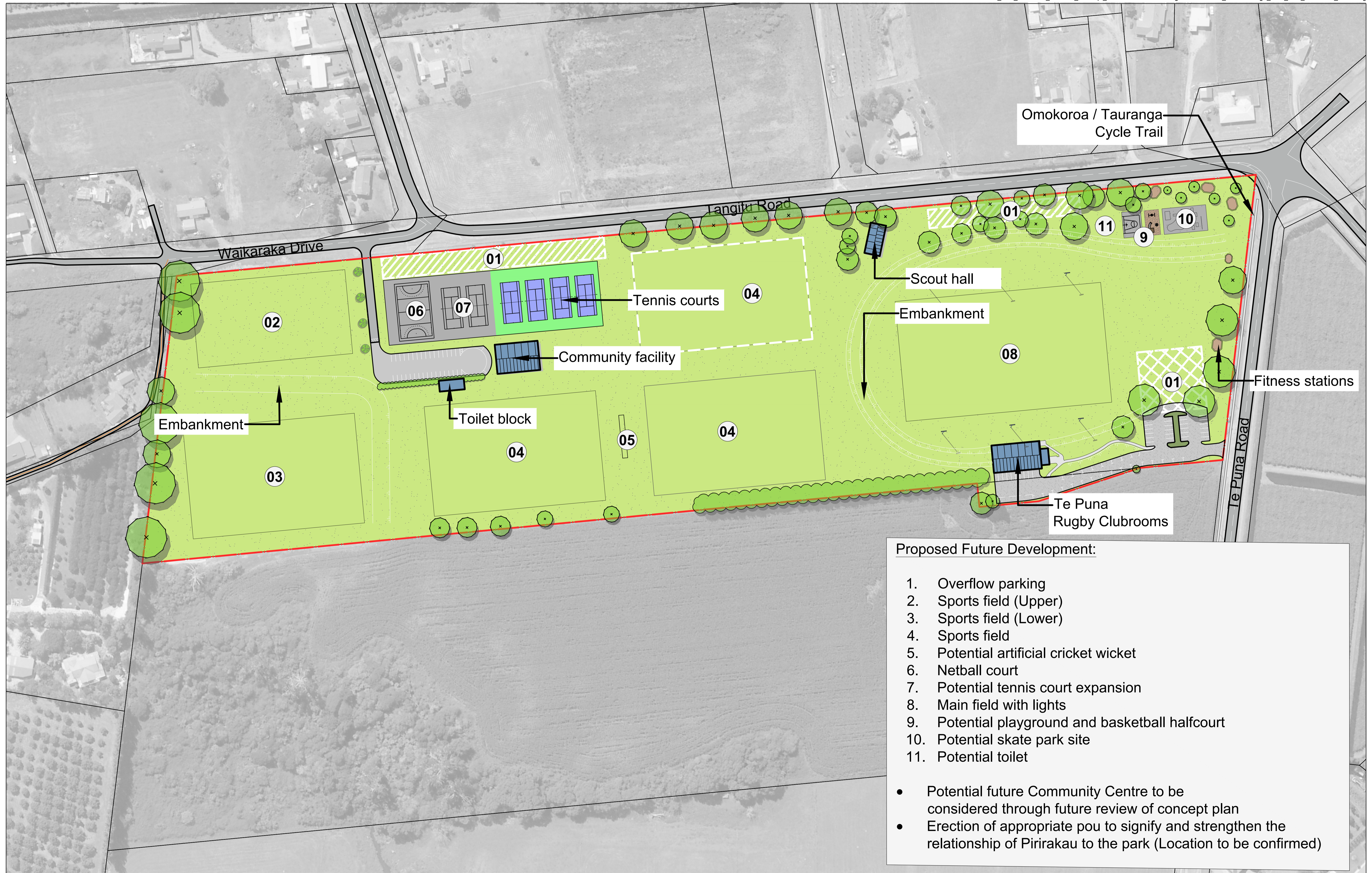

- Proposed Future Development:**
1. Overflow parking
 2. Sports field (Upper)
 3. Sports field (Lower)
 4. Sports field
 5. Potential artificial cricket wicket
 6. Netball court
 7. Potential tennis court expansion
 8. Main field with lights
 9. Potential playground and basketball halfcourt
 10. Potential skate park site
 11. Potential toilet
- Potential future Community Centre to be considered through future review of concept plan
 - Erection of appropriate pou to signify and strengthen the relationship of Pirirakau to the park (Location to be confirmed)

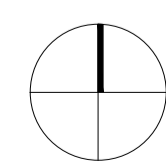

Data Sources:
Projection:

BOPLASS Limited
NZGD2000 N.Z. Transverse Mercator



Scale: 1:1000@A1_1:2000@A3

Legend

- | | | |
|--------------------------|----------------------------|---------------|
| Lawn | Access road and carparking | Site Boundary |
| Sport field | Bund / Bank | Small tree |
| Low amenity planting | Sports field light | Existing tree |
| Erosion control planting | | |

MARAMATANGA PARK

Reserve Concept Plan

| Date: 12/04/2018 | FINAL |

Plan prepared for Western Bay of Plenty District Council by Boffa Miskell Limited
Project Manager: bryan.sanson@boffamiskell.co.nz | Drawn: TKE | Checked: BSA